

# Anchor Handling Tug "Kessab 1"

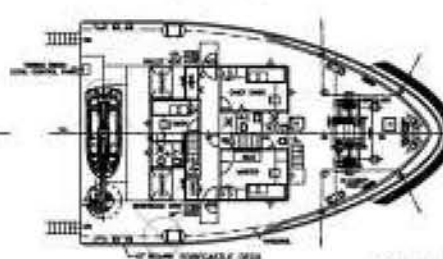

<p><b><u>DIMENSIONS</u></b>  Length Overall: 37.00M  Breadth Moulded: 11.40M  Depth Moulded: 4.95M  Design Draft: 4.00M  Deadweight: 350 metric tonnes  Tonnage: 475 GRT, 143 NRT</p> <p><b><u>MACHINERY:</u></b>  Main Engines: 2 units  Horse Power: 2200BHP @ 1800RPM Auxillary  Engines: 2 x 220BHP @1500RPM  Alternators: 2 x 150KW/415V/50HZ  Propellers: MANGANESE BRONZE/4 BLADE SOLID WITH KEY DIA 2.2M  FIXED PITCH 4.65M IN KORT NOZZLE  Bow Thruster: 3.5T THRUST 350HP (CUMMINS ENGINE)</p> <p>Sewage Treatment Plant: 1.5M<sup>3</sup>/DAY  Steering System: ELECTRO-HYDRAULIC C/W JOYSTICK AT FORWARD AND</p> <p>Oily Water Separator: AFT CONSOLES  Fuel Transfer Pump: Korean Made  30M<sup>3</sup>/HR @ 50M HEAD  Bilge &amp; Ballast Pump: 30M<sup>3</sup>/HR @ 30M HEAD</p> <p><b><u>CAPACITIES:</u></b>  Fuel Oil: APPROX 280M<sup>3</sup>  Fresh Water: APPROX 110M<sup>3</sup>  Lub Oil: APPROX 5M<sup>3</sup>  Dirty Oil: APPROX 5.5M<sup>3</sup>  Industry Icebox: APPROX 8M<sup>3</sup>  Clear Deck Area: 10M X 1M</p> <p><b><u>ACCOMODATION:</u></b>  Crew: 12 men  Cabin: 2 X 1 MAN CABIN  5 X 2 MEN CABIN</p>	<p><b><u>REGISTRATION:</u></b>  Year complete: 2011  Class: Nippon Kaiji Kyokai (NK)  Port of Registry: Abu Dhabi</p> <p><b><u>WINDLASS &amp; MOORING:</u></b>  Towing Winch: double drum 60T, BRAKE 150T  Bollard Pull: 55.12 TONNES  Tugger Winch: 1x 5T  Windlass: 10T AT 0-12M/MIN  Anchors: 2 X STOCKLESS BOWER ANCHOR  Chain: 30MM DIA X 27.5M X 14LENGTH  Mooring drum: 72MM x 200M,</p> <p><b><u>External Fire Fighting:</u></b> 1/2 FIFI</p> <p><b><u>PERFORMANCE:</u></b>  Speed: About 12.2 Knots at sea trial max  Fuel Consumption: 11.00tons MDO per day  Shark Jaw: ME, 100t  Towing pin: ME, 100t  Stern roller: 100t</p> <p><b><u>DECK COVERING:</u></b> WOODEN  <b><u>FENDERING:</u></b> TYRE RUBBER FENDER  Bow: M 300H FENDER  Aft: 300 X 300 DD HOLLOW FENDER</p> <p><b><u>TRANSFER RATES:</u></b>  Fuel: 30 CUBIC METER PER HOUR @ 30M HEAD  Water: 30 CUBIC METRE PER HOUR @ 30M HEAD</p>
--	--

# Anchor Handling Tug "Kessab"

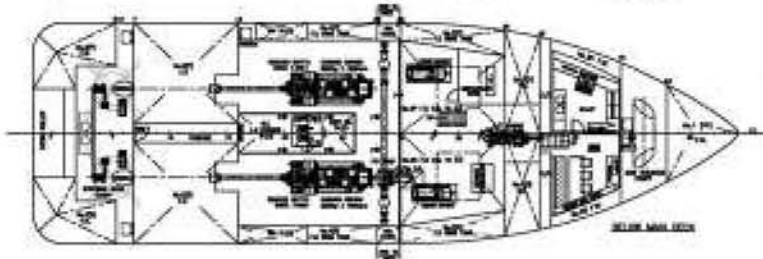
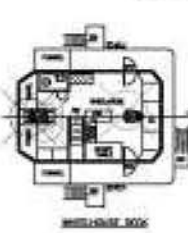
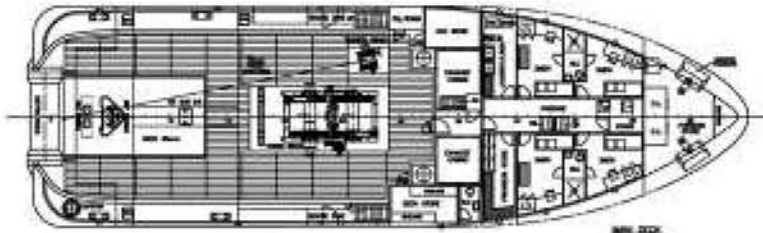
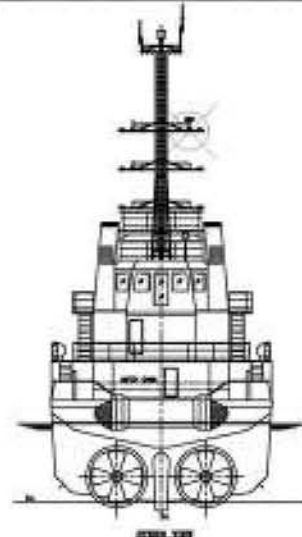
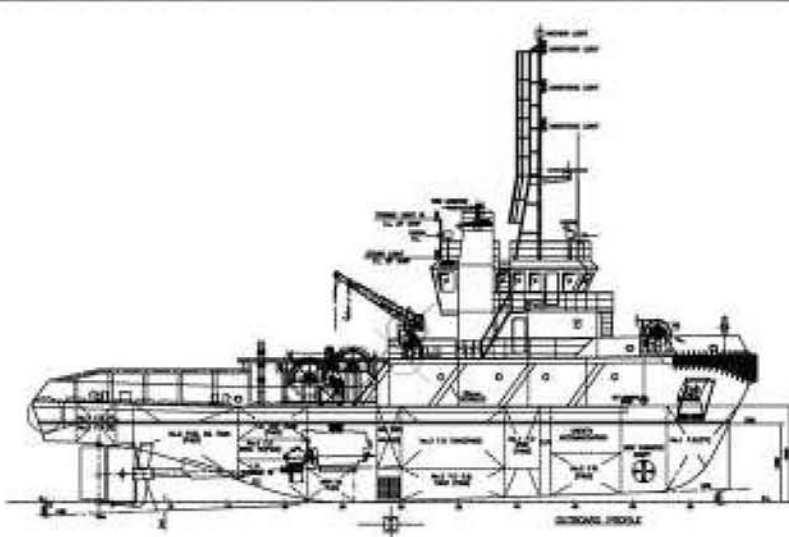

**GENERAL PARTICULARS**

LENGTH O.A.	37.00 m
LENGTH S.P.	31.00 m
LENGTH W.L.	30.00 m
BOW HD.	11.40 m
DEPTH M.D.	4.95 m
DEPTH DECKED	4.00 m
FRESH WATER	110 m <sup>3</sup> (approx.)
FUEL OIL	800 m <sup>3</sup> (approx.)
COMPLIMENT	13 MEN

NAME	Anchor Handling Tug
TYPE	Anchor Handling Tug
GENERAL ARRANGEMENT	
DESIGNED BY	...
CONSTRUCTED BY	...
YEAR	...
SCALE	...
REVISIONS	...